

BRIGHTVIEW 3D

TWP 45-47 RGE 25-27W4M

223 km²

Recorded: April 2005
Instruments: ARAM 24
Source: Dynamite
Charge: 1 x 1kg @ 15m
No. of Traces: 1242 Channels live
Source Int: 60 m
Source Line Spacing: 405.5 m
Receiver Line Spacing: 269.5 m
Receiver Int: 60 m
Bin Size: 30 X 30
Patch Size: 14 x 83
Max Fold: 6300%
Shot by: Tesla Exploration

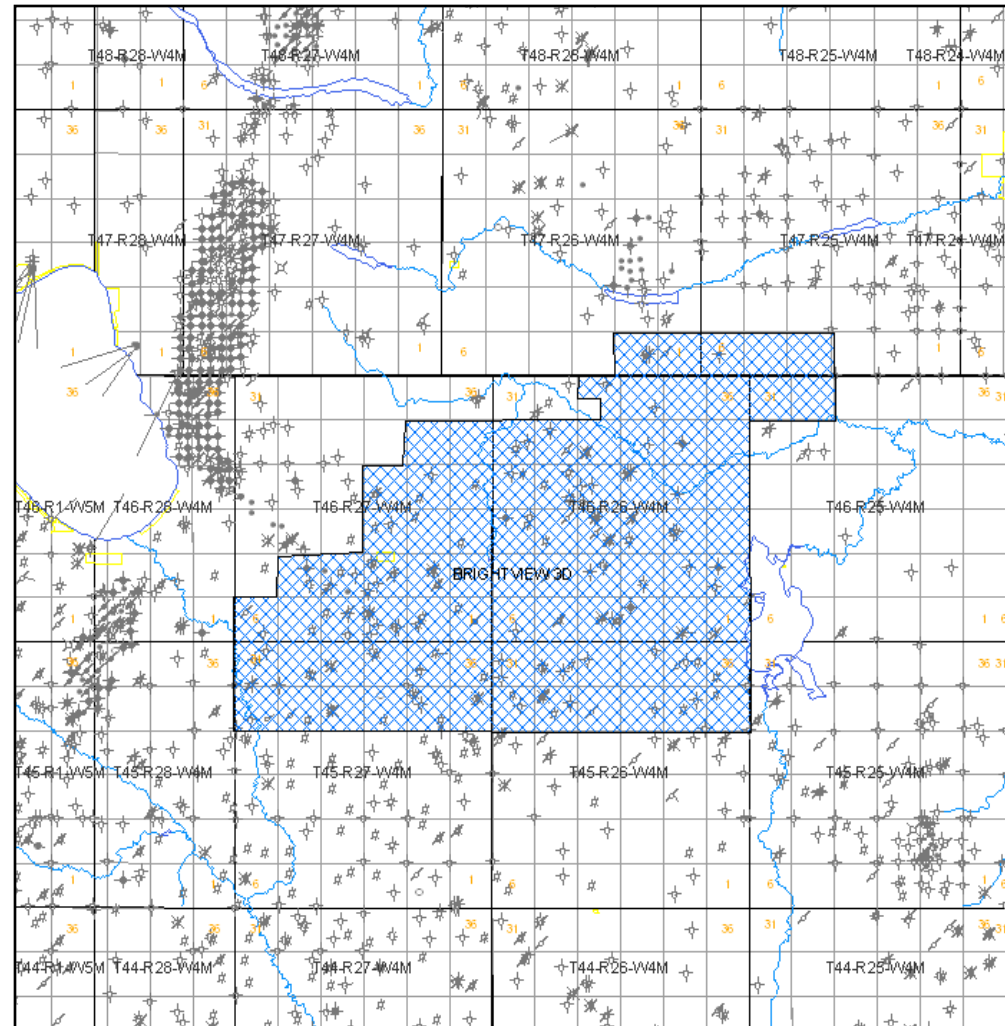

FOR MORE INFORMATION PLEASE CONTACT:
NEAL COLEMAN, KIM NEVADA,
TREVOR MEIER, CURTIS GILLIES OR JEFF BECTOLD
2400, 639 - 5th Avenue SW Calgary, Alberta T2P 0M9
Phone: (403) 237-5559 Fax: (403) 531-9142
www.pulseseismic.com